

Approved by CC:

APR 8 2013



Variance Request for Septic System

Johnson County Subdivision Rules and Regulations state only one septic system per one (1) acre, Section VII A. To request a variance for the purpose of:

- _____ installing a septic system on a lot or tract of less than an acre or
- _____ two residences on one (1) septic system or
- installing a second septic system on a lot less than 2 acres

Please provide the following information. This request will be presented to the Commissioner's Court for their decision.

Owner Asencio Perez Date 3.27.13

Contact Information: Phone no. 817.408.7554

Cell no. 817.219.6302 Email address margarita.p.cenantes@gmail.com

Property Information for Variance Request:

Property 911 address _____

Subdivision name n/a Block _____ Lot _____

Lot size: 1.5 acres Size of existing residence: 1736 sq. ft.

Does this lot currently have a septic system? Yes No System type conventional

ETJ: Yes - City Cleburne No

Is a part of the property located in a FEMA designated Floodplain? Yes No

Reason for request building of second home to have its own septic system

Provide the following with this request:

- Copy of your plat if property has been platted
- Copy of property deed
- Survey or drawing showing existing home, buildings, existing & proposed septic system locations

F:/Platting/Variations/Septic System Variance Request App

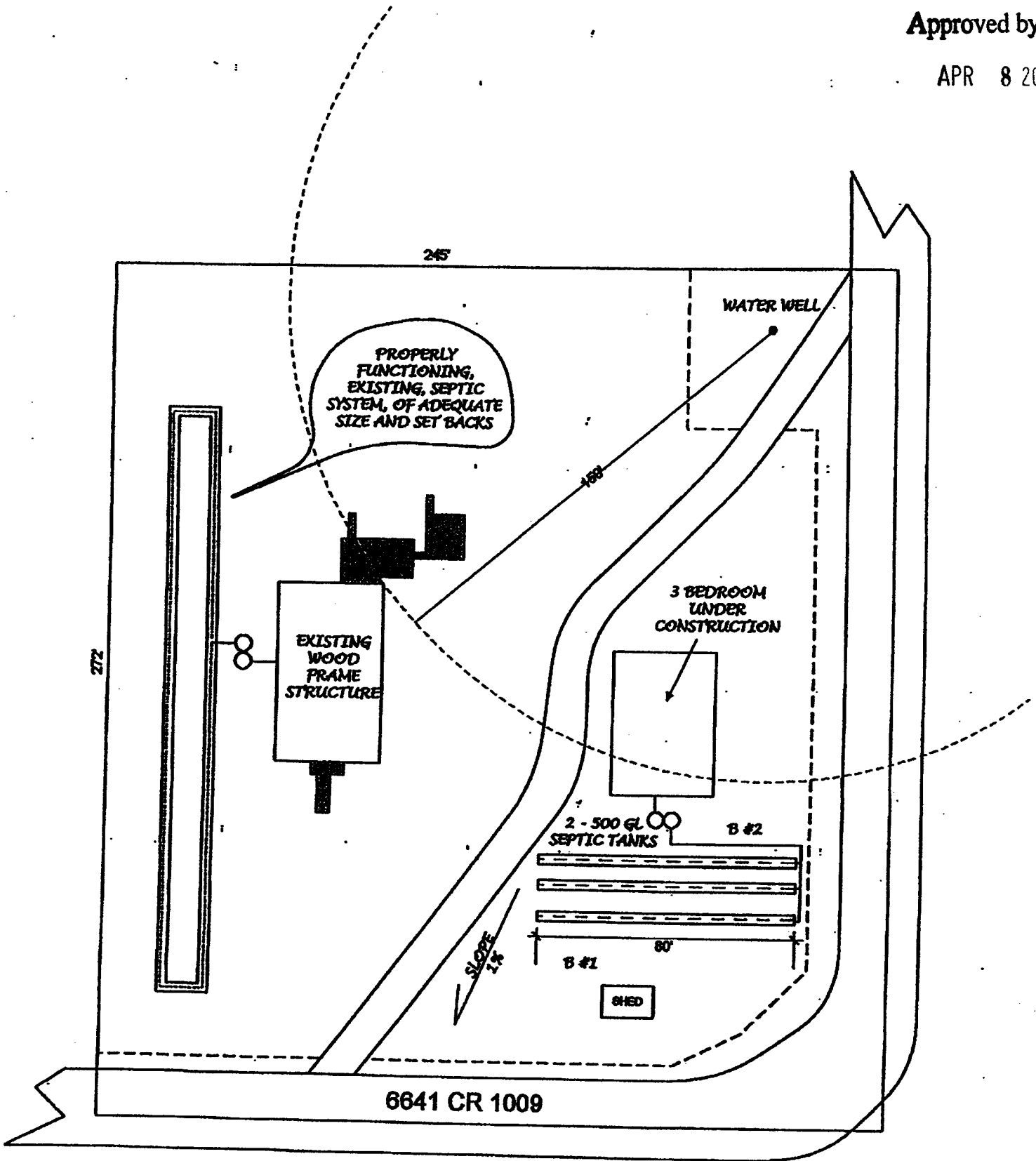

SCALE: 1" = 40' 0"

Thomas Kohl, RS

Professional Sanitarian
5207 Brown Court
Tolar, TX 76476

Telephone 817-739-4234

**DESIGN CRITERIA FOR A PRIVATE SEWAGE DISPOSAL SYSTEM WITH
CONVENTIONAL TRENCH DISPOSAL**

Date: March 20, 2013
Site Location: 6441 CR 1009
Johnson County

Prepared for: Margarita Cervantes and Jabe Robinson

The following information will serve as design documentation for the installation of an OSSF disposal system. This report should be submitted to the permitting authority for review and design approval.

DESIGN PARAMETERS

Estimated Flow:	240 GPD
Soil Type:	Clay Loam
Loading Rate:	.2 gpd/sq. ft.
Area Required:	1,200 sq ft
Area Designed:	1,200 sq ft
Septic Tanks:	2 – 500 gal.

Site Evaluation and Structure:

This is a design for a private residence located on 1.48 acres. The site is suitable for conventional septic disposal. There is a second residence on this tract that is also on a conventional septic system. Due to the age of the original home no permits were required at the time of its construction. I inspected this septic system and found it to be working properly, and constructed in a manner that meets all current state and local guidelines. My investigation also gave evidence of adequate area for the future installation of two legal septic systems on this property, if failure occurs.

Thomas Kohl, RS 2908